

# Old-Berlin

## LED pole-top luminaire

The Old-Berlin is a replication lantern that is true to the original in every technical and aesthetic detail. The lantern is equipped with innovative, energy-efficient LED technology from leading manufacturers. The Old-Berlin lantern achieves a magnificent lighting effect, with a brilliant and natural color rendering that perfectly replicates the light from a historic gaslamp. The golden-yellow illumination gives the environ a lively and natural appearance. The use of premium materials guarantees a long service-life. Thanks to its hinged roof and side-door, it is very easy to maintain (a version without door is also available). By means of its rotationally symmetrical light distribution, this lantern is especially well-suited for the illumination of public squares, streets, residential areas, green spaces and passageways.

### Lighting configurations and materials:

Lantern body and roof: Cast aluminum and aluminum

Reflector: Powder-coated white (RAL 9016)

(choose fitting type: convex or concave)

Replicate historic BAMAG BERLIN remote ignition housing with combustion pipe that serves as a central cableway (non visible cable).

Additional configurations available on request.

### Glazing options:

Plastic (PC) or acrylic (PMMA)

Glass: Safety glass, float glass, mouth-blown Flatglass „restauro“

### Guide frame configuration:

see versions V1, V2 a/b

Additional mounting options available on request.

Standard paint in Onyx Black (iron mica thick-layered paint)

Paint options according to RAL Color Table, as well as FerroGrip special surfacing.

### Lantern-base configurations:

V1: Threaded top for mounting the lamp with the guide frame onto the masthead: Ø85mm or Ø100mm for 4x M12

V2 a: spigot Ø60mm

V2 b: spigot Ø76mm

PlugBox: on/off

PlugBox ESS Basic: manual adjustability of basic brightness

PlugBox ESS Light: manual adjustability of basic brightness | manual adjustability of reduced brightness, switching from basic brightness to reduced brightness over 230VAC control input, (twilight switching / phase cut-off)

Interface: 230VAC

MaxiDimm3000: manual adjustability of basic brightness | manual adjustability of reduced brightness, switching from basic brightness to reduced brightness over 230VAC control input (twilight switching / phase cut-off) variable dimming or segment switch off for symmetric or asymmetrical light distribution, Interface: 230VAC | 1-10V

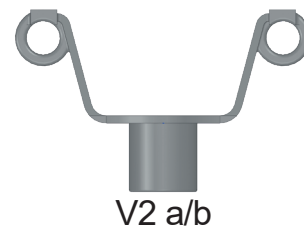
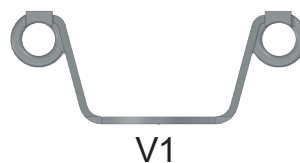

### His.lux® LED-Modul Serie 333



#### TECHNICAL DATA

System power .....	6 - 36 Watt
Expected life .....	>60.000 Std.
Color temperature .....	2700K*
Luminous flux .....	2225 lm (36 Watt)
Color rendering .....	CRI > 85
IP protection class .....	IP 65
Historical diffuser .....	PC satined
Application area .....	-40°C bis +55°C
Protection class .....	I oder II

\*Color temperature freely selectable

### NewNight® CONE LED-Modul



#### TECHNICAL DATA

System power .....	8 - 25 watts
Expected life .....	>60.000 H.
Color temperature .....	4100K*
Luminous flux .....	2620 lm
Color rendering .....	CRI > 85
IP protection class .....	IP 65
LED cover .....	PC transparent or satined
Application area .....	-40°C bis +55°C
Protection class .....	I oder II

\*Color temperature freely selectable

Due to the complexity of the many possible combinations of drivers and LED modules, the values shown for technical LED parameters, including performance parameters, are typical. Actual values of specific products in specific configurations may vary from these typical values. The information and diagrams contained in this document do not constitute an offer or contractual obligation. Product parameters may change as a result of technical innovation and will be undertaken without prior notice. Our manufacturing conforms to DIN-, EN-, and VDE-, CE regulations.